

SIMONSWERK
TECTUS®

distributed in North America by :



1-800-362-1484

www.BridgeportWorldwide.com

TE 645 3D

For flush high performance commercial doors

hinge

Technical Details

load capacity	661 lbs
length (door/frame)	10.236/11.024 "
width (door)	1.339 "
width (frame)	1.417 "
router bit Ø	3/4 "
opening angle	180° degree

Descriptive Text

SIMONSWERK TECTUS hinge TE 645 3D. Completely concealed for flush doors with wood, steel and aluminum frames. With user-friendly 3-way adjustments, load capacity up to 300 kg (661 lbs.), opening angle up to 180°, overall length 280 mm (11.024"), non-handed, maintenance-free slide bearings, three-dimensionally adjustable: side +/- 3.0 mm (0.118"), height +/- 3.0 mm (0.118"), compression +/- 1.0 mm (0.039"). Finish...

Note

The load capacity mentioned above refers to the use of 2 hinges per door leaf with a height/width ratio of 2:1.

Use with a minimum door thickness of 44 mm (1-3/4"). Minimum door thickness of 51 mm (2") when used with steel frames.

Square-corner cover plates are available upon request.

The load capacity shall be reduced by 20% when installed in combination with a door closer.

Product Features

Completely concealed hinge system

For wood, steel or aluminum door panels and frames

For flush high performance commercial doors

Finger protection due to a small gap between door and frame

Easily adjustable in three dimensions (side +/- 3.0 mm (0.118"), height +/- 3.0 mm (0.118"), compression +/- 1.0 mm (0.039"))

Maintenance-free slide bearings

Functional Areas

fire resistance, smoke resistance, soundproof und forced entry resistance

Quality Marks

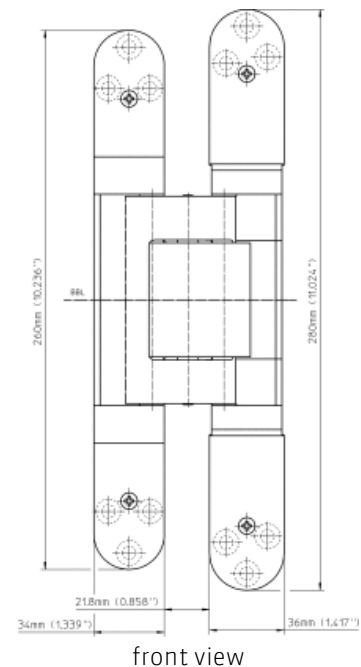

front view

SIMONSWERK

TECTUS®

TE 645 3D

For flush high performance commercial doors

hinge

Combination

receivers	TE 645 3D SZ
receivers	TE 645 3D ST

Installation Tools

universal milling frame long	
template 5 250945 5	24 mm router bit / 30 mm collar ring (frame, step 1)
template 5 250946 5	24 mm router bit / 30 mm collar ring (frame, step 2)
template 5 250947 5	24 mm router bit / 30 mm collar ring (door, step 1)
template 5 250948 5	24 mm router bit / 30 mm collar ring (door, step 2)
template 5 251064 5	3/4" router bit / 1" collar ring (frame, step 1)
template 5 251065 5	3/4" router bit / 1" collar ring (frame, step 2)
template 5 251066 5	3/4" router bit / 1" collar ring (door, step 1)
template 5 251067 5	3/4" router bit / 1" collar ring (door, step 2)

Items (DIN Reference: non-handed)

Finish(es)	powder-coated
packing unit	EUR-pallet
Item Number	5 400634 0 07975
Finish(es)	satin chrome look (F1)
packing unit	pack of 2
Item Number	5 400634 0 12402
Finish(es)	stainless steel look (SSL)
packing unit	pack of 2
Item Number	5 400634 0 12602
Finish(es)	satin-nickel
packing unit	pack of 2
Item Number	5 400634 0 14402

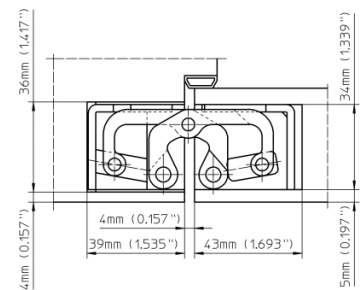

commercial wood frames

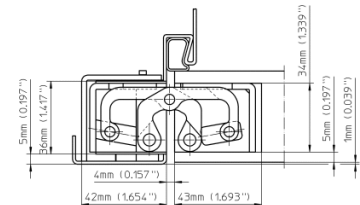

hollow metal frames