

**SIMONSWERK**  
TECTUS®

distributed in North America by :



1-800-362-1484

www.BridgeportWorldwide.com

## TE 640 3D A8

For flush high performance commercial doors with claddings up to 8 mm (0.315")

### hinge

#### Technical Details

load capacity	352 lbs
overall length	9.449 "
width (door)	1.260/1.457 "
width (frame)	1.260/1.457 "
router bit Ø	3/4 "
opening angle	180° degree

#### Descriptive Text

SIMONSWERK TECTUS TE 640 3D A8 hinge for doors with claddings of up to 8 mm (0.315"). Completely concealed for flush doors with wood, steel and aluminum frames. UL listed for 20 minute rated fire doors, with user-friendly 3-way adjustments, load capacity up to 160 kg (352 lbs.), opening angle up to 180°, overall length 240 mm (9.449"), non-handed, maintenance-free slide bearings, three-dimensionally adjustable: side +/- 3.0 mm (0.118"), height +/- 3.0 mm (0.118"), compression +/- 1.0 mm (0.039"). Finish...

#### Note

The load capacity mentioned above refers to the use of 2 hinges per door leaf with a height/width ratio of 2:1.

For a minimum door panel thickness of 40 mm (1-5/8" plus cladding).

For fire rated doors: Check with door manufacturer regarding the usage of additional required intumescent material.

Cover plates for doors without cladding are available upon request.

Square-corner cover plates are available upon request.

#### Product Features

For wood, steel or aluminum door panels and frames

Easily adjustable in three dimensions (side +/- 3.0 mm (0.118"), height +/- 3.0 mm (0.118"), compression +/- 1.0 mm (0.039"))

#### Functional Areas

fire resistance, smoke resistance, soundproof und forced entry resistance

#### Quality Marks



#### Combination

receivers TE 640 3D FZ/1

receivers TE 640 3D A8 SZ

www.simonswerk.com

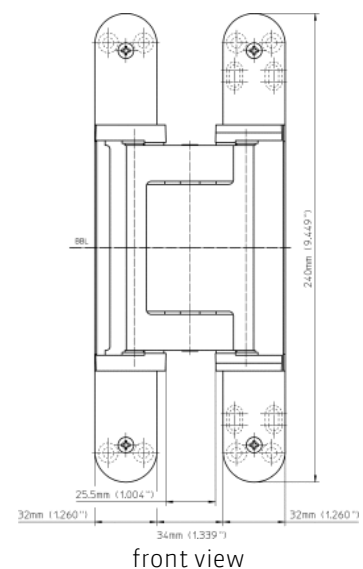

# SIMONSWERK

## TECTUS®

### TE 640 3D A8

For flush high performance commercial doors with claddings up to 8 mm (0.315")

#### hinge

#### Combination

receivers	TE 640 3D/640 3D A8 ST
accessories	cover plate set TECTUS A8 radius

#### Installation Tools

universal milling frame	
template 5 250659 5	24 mm router bit / 30 mm collar ring (step 1)
template 5 250688 5	24 mm router bit / 30 mm collar ring (step 3 (without cladding))
template 5 250689 5	24 mm router bit / 30 mm collar ring (step 2)
template 5 250690 5	24 mm router bit / 30 mm collar ring (step 3)
template 5 251062 5	3/4" router bit / 1" collar ring (step 1)
template 5 251063 5	3/4" router bit / 1" collar ring (step 2)
template 5 251069 5	3/4" router bit / 1" collar ring (step 3)
template 5 251095 5	3/4" router bit / 1" collar ring (step 3 without cladding)

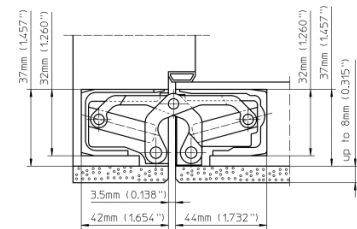

commercial wood frames

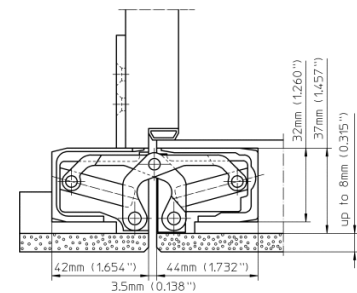

casing wood frames

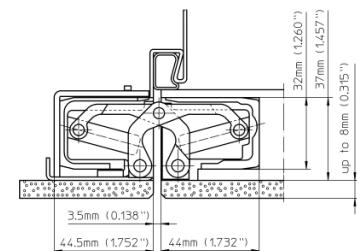

hollow metal frames

# SIMONSWERK

## TECTUS®

### TE 640 3D A8

For flush high performance commercial doors with claddings up to 8 mm (0.315")

hinge

Items (DIN Reference: non-handed)

Finish(es)	polished brass
packing unit	pack of 2
Item Number	5 400617 0 03002
Finish(es)	polished nickel
packing unit	pack of 2
Item Number	5 400617 0 03802
Finish(es)	traffic white - RAL 9016
packing unit	pack of 2
Item Number	5 400617 0 07002
Finish(es)	powder-coated
packing unit	EUR-pallet
Item Number	5 400617 0 07975
Finish(es)	matte deep black - RAL 9005
packing unit	pack of 2
Item Number	5 400617 0 10702
Finish(es)	satin chrome look (F1)
packing unit	pack of 2
Item Number	5 400617 0 12402
Finish(es)	satin nickel look (F2)
packing unit	pack of 2
Item Number	5 400617 0 12502
Finish(es)	stainless steel look (SSL)
packing unit	pack of 2
Item Number	5 400617 0 12602
Finish(es)	satin-nickel
packing unit	pack of 2
Item Number	5 400617 0 14402
Finish(es)	satin chrome
packing unit	pack of 2
Item Number	5 400617 0 14602
Finish(es)	rustic umber
packing unit	pack of 2
Item Number	5 400617 0 15602
Finish(es)	bronze metallic
packing unit	pack of 2
Item Number	5 400617 0 16802
Finish(es)	bronze finish
packing unit	pack of 2
Item Number	5 400617 0 17402
Finish(es)	bronze finish light
packing unit	pack of 2
Item Number	5 400617 0 17502
Finish(es)	bronze finish dark
packing unit	pack of 2
Item Number	5 400617 0 17602

# SIMONSWERK TECTUS®

## TE 640 3D A8

For flush high performance commercial doors with claddings up to 8 mm (0.315")

hinge

While every due care has been taken, we cannot be held responsible for errors, omissions or defects. We kindly ask for your understanding.

© SIMONSWERK North America, Inc.